

PERMCO

2100

2100

COMPACT SMALL DISPLACEMENT ROLLER BEARING SERIES

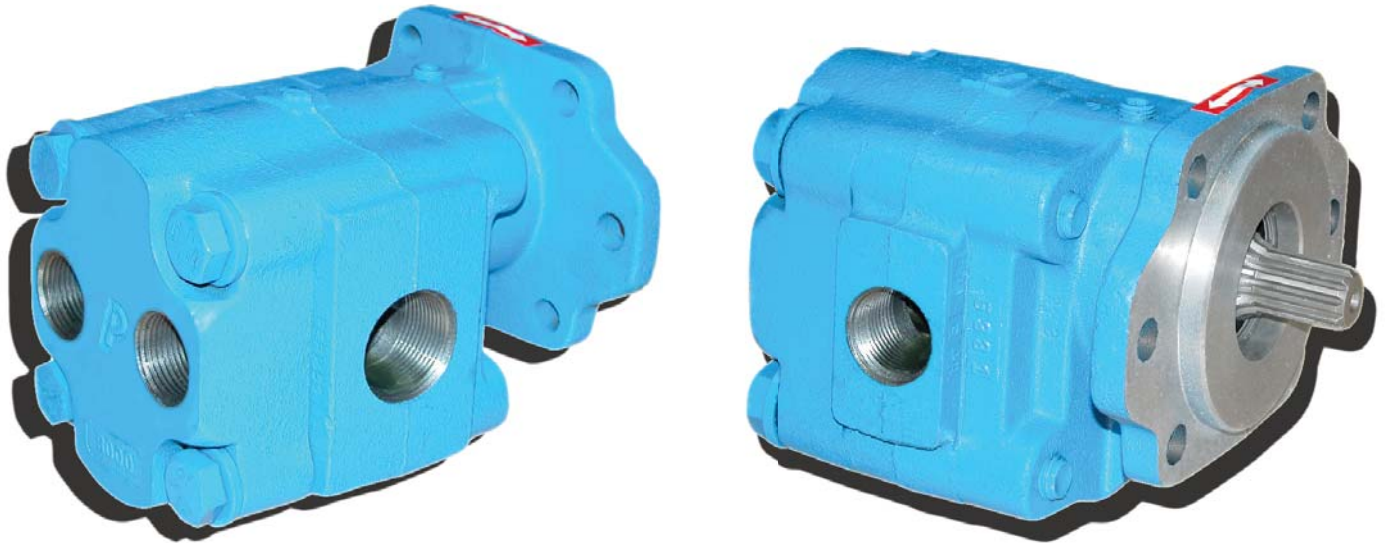

STANDARD UNIT COMBO PORTS/COMBO FLANGE
PUMP/MOTOR

FEATURES

- ❑ Standard features include SAE-B-2&4 bolt mounting flange, SAE-B-spline shaft, both side and rear ports and setup for pump/motor dual rotation applications
- ❑ A wide range of porting, mounting and shaft options available
- ❑ Roller bearing design in a compact small frame size
- ❑ Doweled and high strength cast iron construction
- ❑ Low weight: 34.5 pounds with a 2" gear, Type II
- ❑ Flows up to 39 GPM
- ❑ Working pressure up to 3000 PSI
- ❑ Speeds up to 2400 RPM
- ❑ Cubic inch displacements from 1.00 through 4.00
- ❑ Special ring seals and pressure balanced wear plates maintain high pump and motor efficiency throughout all operating ranges
- ❑ 100% factory tested per application specifications



The Sensible Choice

Dimensional Data (inches)

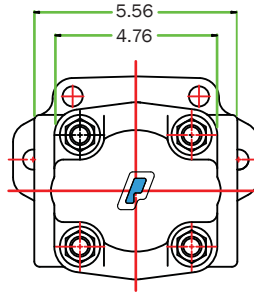
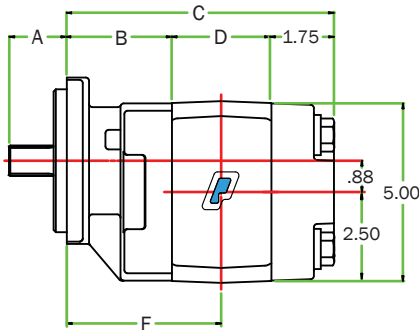

- A. SAE "B" shaft shown, other shafts available
- B. 2.94" Type I, 1.82" Type II
- C. 5.44" Type I, 4.32" Type II plus gear width
- D. .75" plus gear width
- E. 8.69" Type I, 7.57" Type II plus total gear width
- F. 3.31" Type I, 2.19" Type II plus half front gear width
- G. 3.25" plus half total gear width

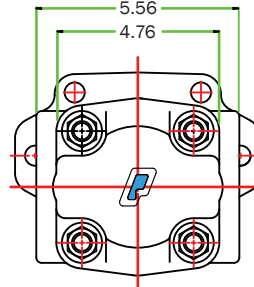
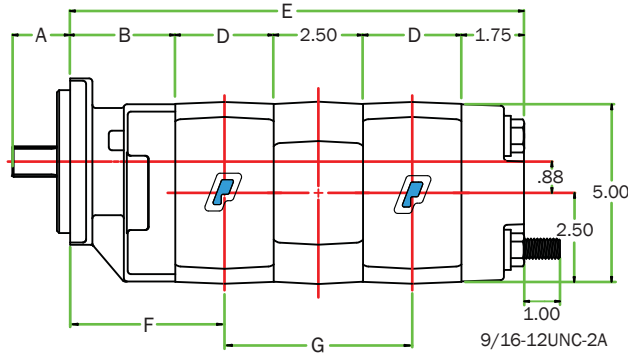

Specifications

Gear Pumps

| Displacement IN ³ /rev | Output GPM 1000 RPM 2000 PSI | Gear Width Inch | Combo/Box Unit | | Max Pressure PSI | Working Speed RPM | | Input HP 1000 RPM 2000 PSI |
|--------------------------------------|------------------------------------|--------------------|-----------------------|------|------------------------|----------------------|-----|----------------------------------|
| | | | Port Size NPT Side | Rear | | Max | Min | |
| 1.00 | ** | 1/2" | 1/2" | 1" | 3000 | 2400 | 600 | ** |
| 1.50 | ** | 3/4" | 3/4" | 1" | 3000 | 2400 | 600 | ** |
| 2.00 | 6.5 | 1" | 1" | 1" | 3000 | 2400 | 600 | 11.6 |
| 2.50 | 8.5 | 1-1/4" | 1" | 1" | 3000 | 2400 | 600 | 15.0 |
| 3.00 | 11.0 | 1-1/2" | 1-1/4" | 1" | 3000 | 2400 | 600 | 18.3 |
| 3.50 | 12.5 | 1-3/4" | 1-1/4" | 1" | 2500 | 2400 | 600 | 21.1 |
| 4.00 | 15.0 | 2" | 1-1/4" | 1" | 2500 | 2400 | 600 | 24.4 |

Gear Motors

| Displacement IN ³ /rev | Input GPM 1000 RPM 2000 PSI | Gear Width Inch | Combo/Box Unit | | Max Pressure PSI | Output Speed RPM | | Output HP 1000 RPM 2000 PSI | Output Torque In. Pounds 1000 RPM 2000 PSI |
|--------------------------------------|-----------------------------------|--------------------|-----------------------|------|------------------------|---------------------|-----|-----------------------------------|---|
| | | | Port Size NPT Side | Rear | | Max | Min | | |
| 1.00 | ** | 1/2" | 1/2" | 1" | 3000 | 2000 | 600 | ** | ** |
| 1.50 | ** | 3/4" | 3/4" | 1" | 3000 | 2000 | 600 | ** | ** |
| 2.00 | 12.0 | 1" | 1" | 1" | 3000 | 2000 | 600 | 9.0 | 570 |
| 2.50 | 14.0 | 1-1/4" | 1" | 1" | 3000 | 2000 | 600 | 11.5 | 730 |
| 3.00 | 16.5 | 1-1/2" | 1-1/4" | 1" | 3000 | 2000 | 600 | 14.0 | 895 |
| 3.50 | 19.0 | 1-3/4" | 1-1/4" | 1" | 2500 | 2000 | 600 | 16.5 | 1035 |
| 4.00 | 21.0 | 2" | 1-1/4" | 1" | 2500 | 2000 | 600 | 18.6 | 1175 |

** Performance dependent upon application parameters: Consult Factory

In accordance with our policy of continued product development, we reserve the right to change specifications without notice. The data is average test data and should not be misconstrued to represent performance of each units.

Permco
1500 Frost Rd.
P. O. Box 2068
Streetsboro, OH 44241

Phone 330-626-2801
Fax 330-626-2805
e-mail info@permco.com
www.permco.com

Permco Hydraulik AG
P. O. Box 553
6343 Rotkreuz
Switzerland
e-mail: heinz.m@permco.com

Permco (TianJin) Hydraulics Inc., Ltd.
236 Jinbindadao Free Trade Zone
TianJin Port, China
e-mail: technic@permcotj.com
www.permcotj.com